

km
Karenhills

SIGNATURE HOMES

km
Karenhills

SIGNATURE HOMES

Welcome to Karen Hills

Karen Hills is truly unique. A master-planned gated community that offers residents world-class infrastructure, a secure and peaceful environment and a host of on-site amenities and services devised to maximise the quality of community life. All plots at Karen Hills are one acre, fully

serviced with a choice of locations and aspects to suit all. Karen boasts modern shopping malls, office space, excellent private schools, a modern hospital, and numerous social and recreational facilities.



A treasured secret

Sometimes it takes a while for a treasured secret to slowly reveal itself . . .

This secret gem that is Karen Hills is quite simply the most sought-after piece of paradise in Karen.

Professionals and business leaders that have already discovered Karen Hills are most impressed with their early investment and increased values.

The roads and all infrastructure services are completed, the great perimeter stone wall and sophisticated security features are installed, the added-values of indigenous landscaping, street lighting, the Gazebo and recreational facilities, are all done and now waiting for you.



This is the life . . .



This is the life at Karen Hills

- Fully serviced one acre plots.
- Providing safety and security for your family lifestyle.
- Sophisticated security systems, CCTV's, electronic access cards, automated lighting, guard patrol monitors, instant emergency response.
- The Gazebo entertainment and social get-together area.
- Tennis court, basketball, a sports field and kiddies play area.
- Professional Management Company.

Karen Hills

Surrounded by nature and a clean healthy environment . . .



Introducing . . .
SIGNATURE HOMES

Born from the creativity of leading international Architects and Interior Designers, and drawn from the elements of nature, these inspirational home designs vary in their style from classical to contemporary, but always with inherent excellence and elegance.

Engage with us and explore this new concept of your special home which can be made both unique and bespoke to your requirements.

Karen Hills and Signature Homes embodies the essence of a quality investment, and, the *joie de vivre* of owning your special home with its fantastic family lifestyle.

joie de vivre | "a feeling of enjoyment or excitement about life, an exultation of spirit . . ."



*. . . formulate your dreams into reality,
and make your Signature Home unique
and bespoke, crafted for you!*



Flame Tree

Flame Tree Home

Evolved from the Architect studying the land, the climate, and absorbing the atmosphere of Karen Hills, Flame Tree Home is designed to create a unique habitable experience in the beautifully benign climate that Kenya offers, with flowing spaces that embrace the concept of “indoor-outdoor living”.

Taking advantage of the panoramic views to the Ngong Hills, with a broad frontage of Living, Dining and Family Kitchen spaces all facing this view, these rooms spill out to the Terrace and rim-flow swimming pool, so naturally and practically extending their use and enjoyment.

The Living and Dining experiences are enhanced by fireplaces, a theme which is carried to the outdoors with a special Terrace Firepit for evening and night-time relaxing and entertainment, overlooking the gently sloping garden.



Tamarind

Tamarind Home

From our forefathers, and their ritual gathering under the shade of the Tamarind Tree for social discourse and matters more serious, we take inspiration for the Tamarind Home, with the living spaces gathered around the central Courtyard.

This Courtyard is overflowing with plants and filled with light that penetrates into the heart of the home.

The outdoor spaces are flexibly arranged in such a way that the Living, Dining, and Family Room spaces can be enjoyed as a range of entertainment and relaxing experiences, with direct connection to the crystal clear swimming pool.

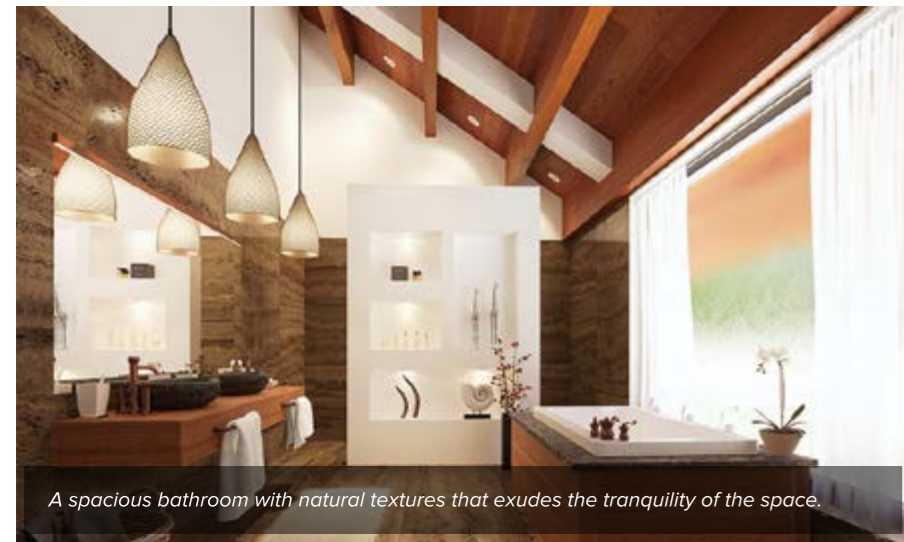

A spacious bathroom with natural textures that exudes the tranquility of the space.

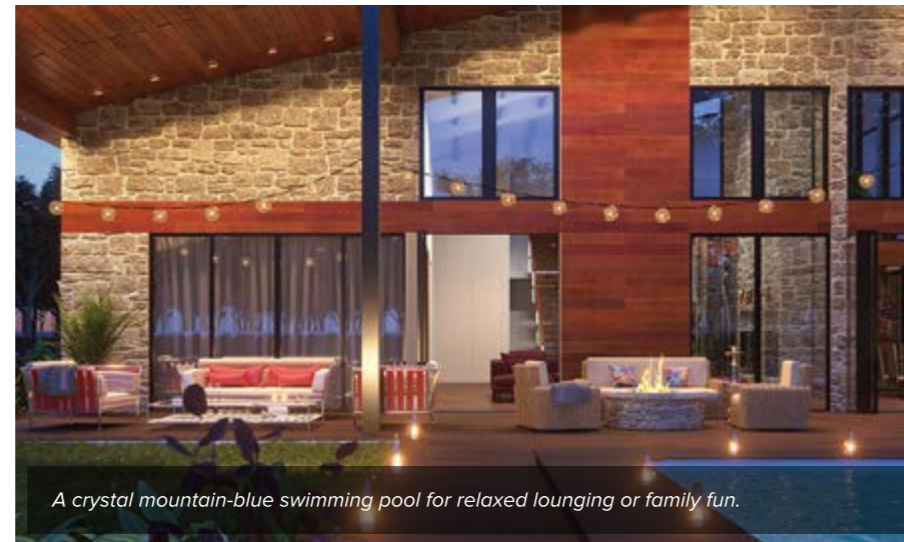

A crystal mountain-blue swimming pool for relaxed lounging or family fun.



Beautiful indoor spaces that embrace a lush garden courtyard at its heart.

Nsika

Nsika Home

Conjuring up images of the gracious Plantation Architecture that is so appropriate for this wonderful climate of Karen Hills, the handsome Nsika Home is all about stately entrances, high double volumes, generous spaces, and the advantage of exclusive privacy for the family.

This is an Architecture that provides for grandeur through simple but carefully proportioned spaces and circulation flows, with elegant solutions of extraordinary indoor-outdoor living experiences.

The Nsika Home embraces the family, and the sheltered and shuttered Terrace provides the most wonderful sunset and evening space for savoring the culinary delights of the evening's fare, whether a home-cooked barbecue, a social gathering of friends and family, or just a peaceful ending to the day.



With dusk, the terrace and pool area offer a haven of calm and tranquility.

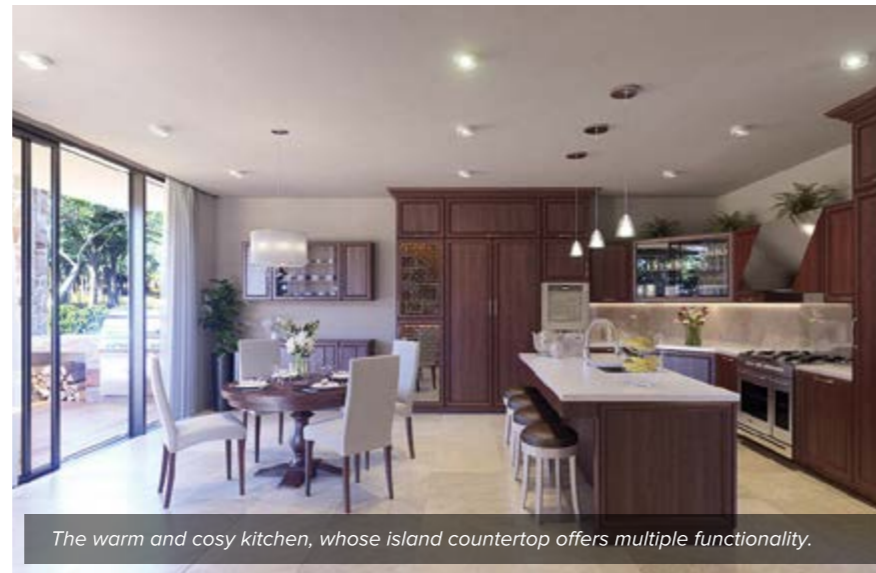

The warm and cosy kitchen, whose island countertop offers multiple functionality.



Bright cathedral volumes with the natural elements of wood and stone.

Kalamata

Kalamata Home

Taste is always such a strong sensory memory, and savouring the unique taste of the Kalamata olive is our introduction to the Kalamata Home, reflecting the associated Mediterranean memories of long distance views of hillsides cloaked with olive trees and children playing safely in the garden and swimming pool.

This is a home for large families and hard-working parents, with ample spaces to be together, but also to retreat to your private sanctuaries. The generous sizing and the variety of rooms are a pleasure for providing flexible options of room and space allocations.

The high ceilings and classical design with a wonderful light-filled Courtyard, lend an air of gracious living in a stately mansion.



Lavender and tropical flowers gives a warm invitation to the palatial elegant home.



Pool loungers and garden play areas - a family resort atmosphere.



Symmetry and soothing natural colours maintains peace in this space keeping things airy and atmospheric.

Butterfly Butterfly Home

In the verdant Karen Hills Estate there are a myriad of butterflies with their conspicuous fluttering flight, and it is this graceful image that inspired the design of the Butterfly Signature Home.



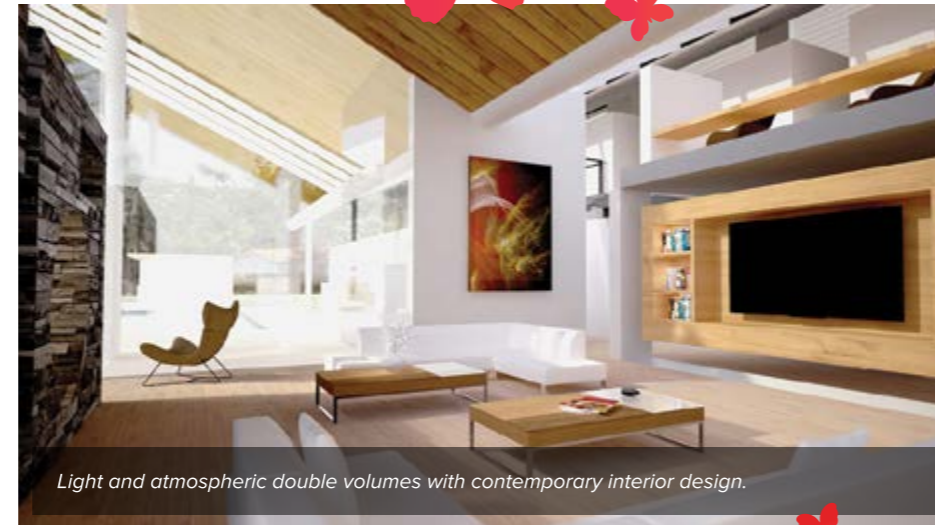

The result is two pavilions with sweeping butterfly-wing roofs with a central “spine” forming the metaphorical body of the butterfly, and this light-filled “spine” harvesting the rainwater which spills out each end into sparkling water features.

The double-volume Living and Dining rooms can be opened up entirely to their Terraces so that indoor and outdoor realms are joined as one living space, flowing seamlessly to the outdoor terraces.



Master Plan

LEGEND

-  Building Envelope (this is the area you are allowed to build on the plot 25m x 25m)
-  Existing Trees
-  New Indigenous Trees
-  Perimeter Security Walkway (approx. 2500m)
-  Road



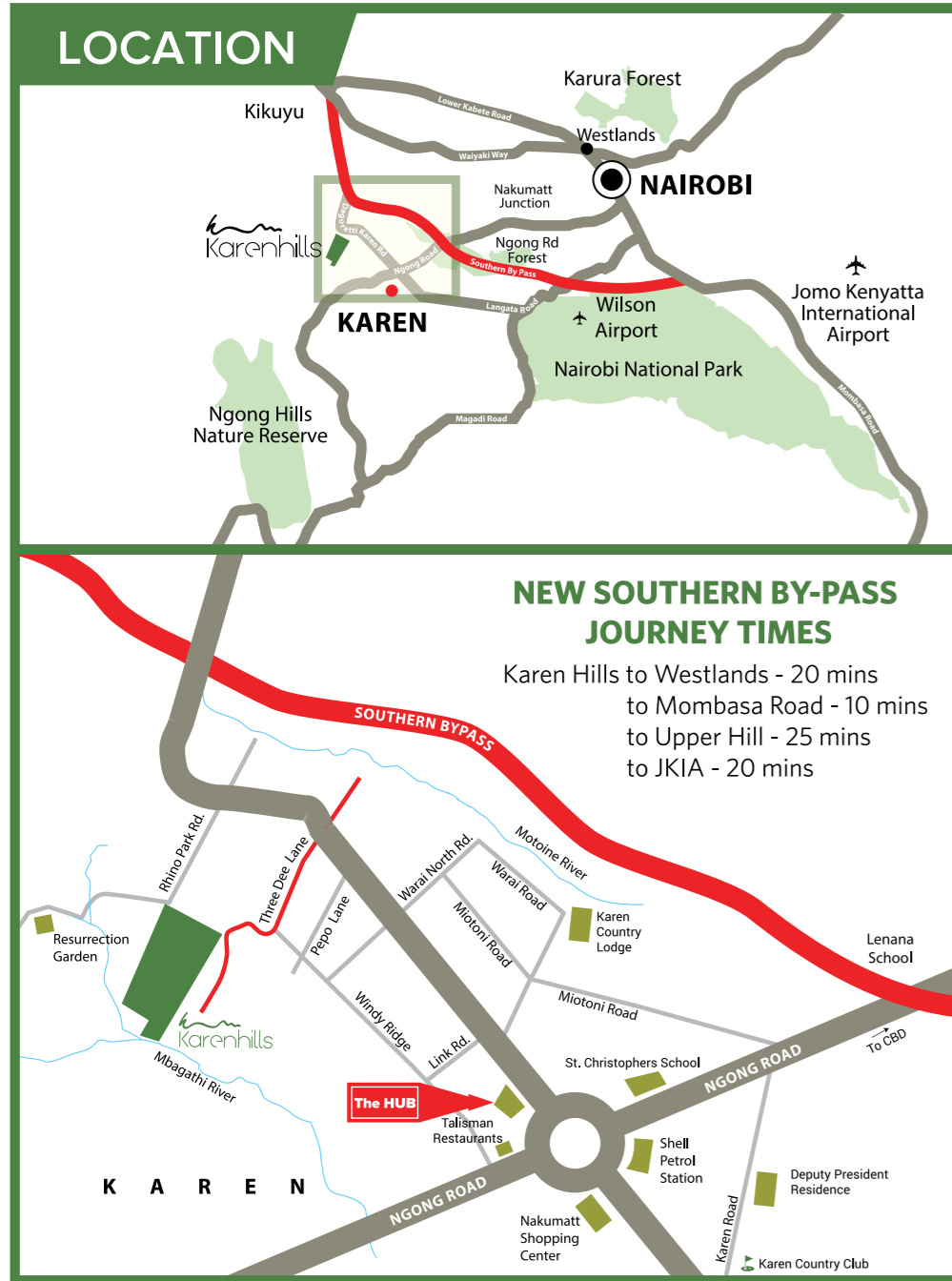

- Karen is home to The Hub shopping mall, the best schools, restaurants, and hospitals
- Karen Hills is set to take full advantage of the new Southern Bypass
- 2 interchange options with easy commuting distances to all destinations
- The upgrade of Ngong Road to a dual carriageway has already started
- As commuting becomes relieved, Karen property values increase
- Excellent sport, hiking, equestrian and golfing facilities



Karen Hills Sales Office
 Bishops Court, 4th Ngong Avenue
 P.O. Box 47655-00100
 Nairobi, Kenya.

Email: sales@karenhills.co.ke

DISCLAIMER Karen Hills Limited and the Developers, make no representations or warranties about the accuracy, completeness, or suitability for any purpose of the information and related graphics published in this brochure. The information contained herein may contain technical inaccuracies, omissions or typographical errors. All liability of Karen Hills Limited or the Developers howsoever arising or any such inaccuracies, omissions or errors is expressly excluded to the fullest extent permitted by law. Neither Karen Hills Limited nor the Developers nor any of their directors, employees, agents, advisors or other representatives will be liable for any loss or damage arising out of or in reliance on or in connection with the use of this brochure. This is a comprehensive limitation of liability that applies to all damages of any kind, including (without limitation) compensatory, direct, indirect or consequential damages, loss of data, income or profit, loss of or damage to property and claims of third parties. Notwithstanding the foregoing, none of the exclusions and limitations above are intended to limit any consumer statutory rights which may not be excluded by law.

Developed by:



LORDSHIP AFRICA

Call us: **0705 253 272**
www.karenhills.co.ke

Karenhills
SIGNATURE HOMES